

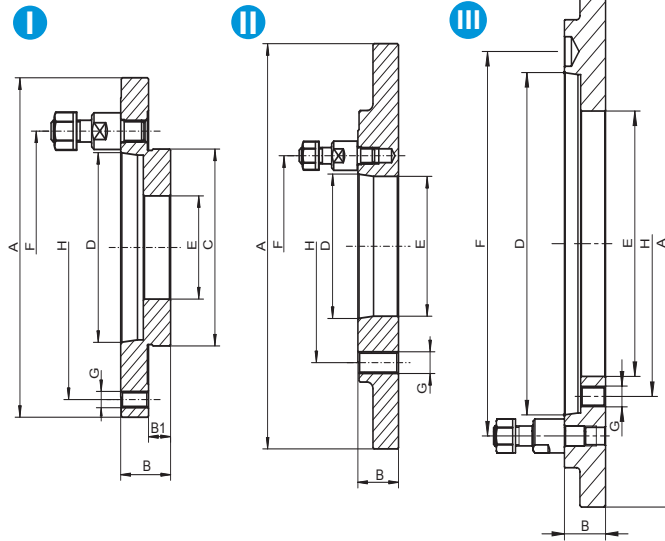

FULLY MACHINED ADAPTER PLATES FOR SET-TRU CHUCKS

8235
TYPE C



W - Chuck diameter Z - adapter form

Code No.	W*	Taper Size	Z*	A [in]	B [in]	B1 [in]	C [in]	D [in]	E [in]	F [in]	G	H [in]	Weight [lbs]
7-920-043	4"	3	I	3.94	1.22	0.47	1.77	2.13	0.79	2.95	M8	3.27	2.87
7-920-044	4"	4	I	4.13	1.22	0.47	1.77	2.50	0.79	3.35	M8	3.27	2.65
7-920-053	5"	3	I	4.92	1.30	0.55	2.17	2.13	1.38	2.95	M8	4.25	3.97
7-920-054	5"	4	I	4.92	1.30	0.55	2.17	2.50	1.38	3.35	M8	4.25	3.75
7-920-055	5"	5	I	5.12	1.38	0.55	2.17	3.25	1.38	4.13	M8	4.25	3.97
7-920-063	6"	3	I	6.30	1.26	0.63	3.39	2.13	1.65	2.95	M10	5.51	6.17
7-920-064	6"	4	I	6.30	1.26	0.63	3.39	2.50	1.65	3.35	M10	5.51	6.17
7-920-065	6"	5	I	6.30	1.46	0.63	3.39	3.25	1.65	4.13	M10	5.51	6.61
7-920-084	8"	4	I	7.87	1.30	0.67	4.33	2.50	2.17	3.35	M10	6.93	8.82
7-920-085	8"	5	I	7.87	1.30	0.67	4.33	3.25	2.17	4.13	M10	6.93	9.70
7-920-086	8"	6	I	7.87	1.57	0.67	4.33	4.19	2.17	5.25	M10	6.93	11.68
7-920-105	10"	5	I	9.84	1.50	0.75	5.71	3.25	2.99	4.13	M12	8.82	18.52
7-920-106	10"	6	I	9.84	1.50	0.75	5.71	4.19	2.99	5.25	M12	8.82	17.42
7-920-108	10"	8	I	9.84	1.69	0.75	5.71	5.50	2.99	6.75	M12	8.82	22.71
7-920-126	12"	6	I	12.40	1.69	0.75	7.09	4.19	4.06	5.25	M16	11.26	28.44
7-920-128	12"	8	I	12.40	1.69	0.75	7.09	5.50	4.06	6.75	M16	11.26	33.07
7-920-129	12"	11	I	12.40	1.97	0.75	7.09	7.75	4.06	9.25	M16	11.26	39.46
7-920-166	16"	6	II	11.75	1.38	-	11.75	4.19	4.06	5.25	5/8-11	6.75	28.22
7-920-168	16"	8	II	11.75	1.46	-	11.75	5.50	5.35	6.75	5/8-11	6.75	33.07
7-920-169	16"	11	II	11.75	1.46	-	11.75	7.75	4.72	9.25	5/8-11	6.75	37.48
7-920-208	20"	8	II	16.02	1.42	-	16.02	5.50	5.35	6.75	3/4-10	9.25	69.45
7-920-209	20"	11	II	16.02	1.42	-	16.02	7.75	7.59	9.25	3/4-10	9.25	65.26
7-920-215	20"	15	II	16.02	2.05	-	16.02	11.25	7.48	9.25	3/4-10	9.25	85.98
7-920-258	25"	8	II	16.02	1.42	-	16.02	5.50	5.35	6.75	3/4-10	13.00	69.45
7-920-259	25"	11	II	16.02	1.42	-	16.02	7.75	7.59	13.00	3/4-10	13.00	65.26
7-920-265	25"	15	II	16.02	2.05	-	16.02	11.25	9.92	13.00	3/4-10	13.00	74.96
7-920-329	32"	11	II	25.00	1.42	-	25.00	7.75	7.59	9.25	M24	14.50	163.58
7-920-335	32"	15	II	25.00	1.57	-	25.00	11.25	11.06	13.00	M24	14.50	163.14
7-920-322	32"	20	III	25.00	2.28	-	25.00	16.25	12.60	18.25	M24	14.50	176.59
7-920-415	40"	15	II	25.00	1.57	-	25.00	11.25	11.06	13.00	M24	18.25	163.58
7-920-420	40"	20	II	25.00	1.57	-	25.00	16.25	16.06	18.25	M24	18.25	121.25
7-920-495	49"	15	II	28.35	1.97	-	28.35	11.25	11.06	13.00	M30	25.50	264.55
7-920-492	49"	20	II	28.35	1.97	-	28.35	16.25	16.06	18.25	M30	25.50	218.26