

1

2

3

4

5

## FULLY MACHINED SC ADAPTER PLATES FOR QUICK CLAMPING CHUCKS

8287

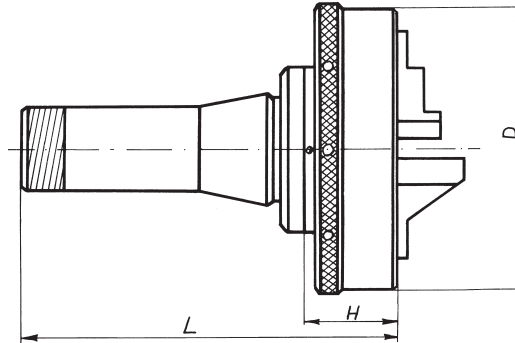

D - Chuck diameter

Code No.	D	L [in]	H [in]	Thru Hole Diameter [in]
7-910-604	3" 4"	5.43	1.57	0.87
7-910-605	5"	5.75	1.89	0.87
7-910-606	6"	5.83	2.05	0.87

## FULLY MACHINED SC ADAPTER PLATES FOR SET-TRU CHUCKS

8288



W - Chuck diameter

Code No.	W
7-912-304	4"
7-912-305	5"
7-912-306	6"