



3574-P



Standard accessories

1 Set of hard solid ID jaws

1 Set of hard solid OD jaws

1 Wrench

Spare parts 99-141

Technical data 142-148

Code No.	Type
7-817-0300P	3574-3"-P
7-817-0400P	3574-4"-P
7-817-0500P	3574-5"-P
7-817-0600P	3574-6"-P
7-817-0800P	3574-8"-P
7-817-1000P	3574-10"-P
7-817-1200P	3574-12"-P
7-817-1600P	3574-16"-P
7-817-2000P	3574-20"-P
7-817-2500P	3574-25"-P

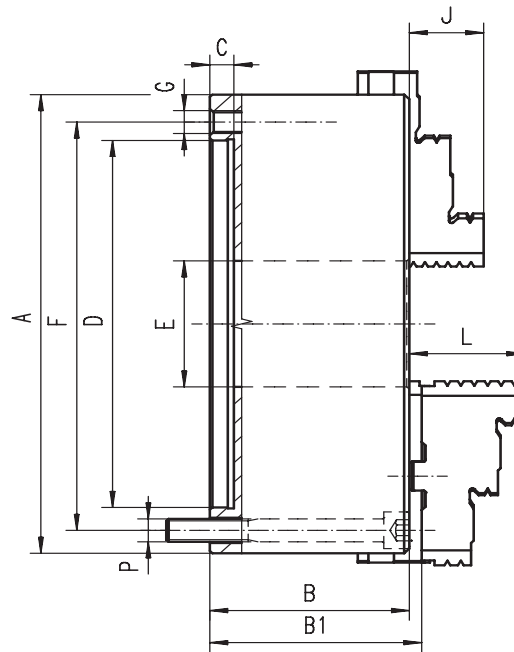

- BISON PREMIUM chucks are characterized by exceptionally high accuracy values for all operations that require maximum precision - specially designed for our most demanding customers
- Hardened and ground working surfaces
- Balanced scroll plate
- Chucks ø20" and above have additional T-slots
- Flexible mounting system: mounting from the back or front of the chuck by use of an adapter plate

A [in]	B [in]	B1 [in]	C [in]	D H7 [in]	E [in]	F [in]	G	J [in]	L [in]	P	Weight [lbs]
3.15	1.73	-	0.12	2.20	0.63	2.64	3xM6	0.51	-	3xM6	3.31
3.94	1.97	-	0.12	2.76	0.79	3.27	3xM8	0.63	-	3xM8	6.17
4.92	2.34	2.53	0.16	3.74	1.40	4.25	3xM8	0.79	1.57	3xM8	11.02
6.30	2.68	2.87	0.16	4.92	1.65	5.51	3xM10	1.26	1.69	3xM10	22.05
7.87	3.07	3.26	0.16	6.30	2.17	6.93	3xM10	1.14	1.77	3xM10	38.58
9.84	3.50	3.65	0.20	7.87	2.99	8.82	3xM12	1.34	2.09	3xM12	63.93
12.40	3.83	3.99	0.20	10.24	4.06	11.26	3xM16	1.69	2.24	3xM16	110.23
15.75	4.29	4.60	0.20	12.99	5.35	14.25	3xM16	2.17	2.64	3xM16	187.39
19.69	4.69	5.11	0.20	16.54	7.48	18.03	6xM16	2.36	3.11	6xM16	319.67
24.80	5.08	5.52	0.28	21.46	9.92	23.07	6xM16	2.76	3.43	6xM16	551.16

Larger diameters available on page 82-93!

3575-P



Standard accessories

1 Set of hard top jaws

1 Set of hard master jaws

1 Wrench

Spare parts 99-141

Technical data 142-148

Type	Code No.
-	-
-	-
3575-5"-P	7-813-0500P
3575-6"-P	7-813-0600P
3575-8"-P	7-813-0800P
3575-10"-P	7-813-1000P
3575-12"-P	7-813-1200P
3575-16"-P	7-813-1600P
3575-20"-P	7-813-2000P
3575-25"-P	7-813-2500P