

1  
2  
3  
4  
5  
6



# 3514



Standard accessories



1 Set of hard solid ID jaws



1 Set of hard solid OD jaws



1 Wrench

Spare parts 99-141

Technical data 142-148

Code No.	Type
7-822-0615	3514-6"-5
7-822-0814	3514-8"-4
7-822-0815	3514-8"-5
7-822-0816	3514-8"-6
7-822-1015	3514-10"-5
7-822-1016	3514-10"-6
7-822-1018	3514-10"-8
7-822-1226	3514-12"-6
7-822-1228	3514-12"-8
7-822-1626	3514-16"-6
7-822-1628	3514-16"-8
7-822-1629	3514-16"-11
7-822-2028	3514-20"-8
7-822-2029	3514-20"-11
7-822-2529	3514-25"-11
7-822-2530	3514-25"-15

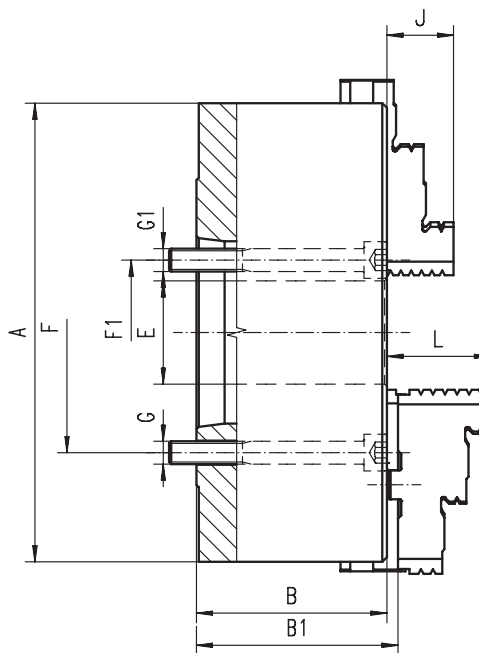

- Hardened and ground working surfaces
- Balanced scroll plate
- Chucks ø20" and above have additional T-slots

A [in]	Taper Size	B [in]	B1 [in]	E [in]	F [in]	F1 [in]	Number of bolts	3514		3515		J [in]	L [in]	Weight [lbs]
								G	G1	G	G1			
6.30	5	2.68	2.87	1.65	-	2.44	3	-	3xM10	-	7/16-14	1.26	1.69	22.05
7.87	4	3.07	3.26	1.65	3.25	-	3	3xM10	-	7/16-14	-	1.14	1.77	41.89
7.87	5	3.07	3.26	1.65	-	2.44	3	-	3xM10	-	7/16-14	1.14	1.77	41.89
7.87	6	3.07	3.26	2.17	-	3.25	3	-	3xM12	-	1/2-13	1.14	1.77	41.89
9.84	5	3.50	3.65	2.99	4.13	-	3	3xM10	-	7/16-14	-	1.34	2.09	70.55
9.84	6	3.50	3.65	2.17	-	3.25	6	-	6xM12	-	1/2-13	1.34	2.09	70.55
9.84	8	3.50	3.65	2.99	-	4.37	6	-	6xM16	-	5/8-11	1.34	2.09	70.55
12.40	6	3.79	3.99	4.06	5.25	-	6	6xM12	-	1/2-13	-	1.69	2.24	121.25
12.40	8	3.79	3.99	3.15	-	4.37	6	-	6xM16	-	5/8-11	1.69	2.24	121.25
15.75	6	4.25	4.60	4.06	5.25	-	6	6xM12	-	1/2-13	-	2.17	2.64	202.83
15.75	8	4.25	4.60	5.35	6.75	-	6	6xM16	-	5/8-11	-	2.17	2.64	202.83
15.75	11	4.25	4.60	5.12	-	6.50	6	-	6xM20	-	3/4-10	2.17	2.64	202.83
19.69	8	4.69	5.11	5.35	6.75	-	6	6xM16	-	5/8-11	-	2.36	3.11	352.74
19.69	11	4.69	5.11	7.48	9.25	-	6	6xM20	-	3/4-10	-	2.36	3.11	352.74
24.80	11	5.08	5.52	7.48	9.25	-	6	6xM20	-	3/4-10	-	2.76	3.43	628.32
24.80	15	5.08	5.52	9.92	13.00	-	6	6xM24	-	7/8-9	-	2.76	3.43	628.32

Larger diameters available on page 82-93!

# 3515



Standard accessories



1 Set of hard top jaws



1 Set of hard master jaws



1 Wrench

Spare parts 99-141

Technical data 142-148

Type	Code No.
3515-6"-5	7-821-0615
3515-8"-4	7-821-0814
3515-8"-5	7-821-0815
3515-8"-6	7-821-0816
3515-10"-5	7-821-1015
3515-10"-6	7-821-1016
3515-10"-8	7-821-1018
3515-12"-6	7-821-1226
3515-12"-8	7-821-1228
3515-16"-6	7-821-1626
3515-16"-8	7-821-1628
3515-16"-11	7-821-1629
3515-20"-8	7-821-2028
3515-20"-11	7-821-2029
3515-25"-11	7-821-2529
3515-25"-15	7-821-2530

3514

3515



Type of mounting



Material of chuck body



Number of jaws



Type of jaws