

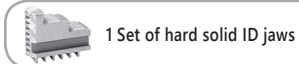

3214



Standard accessories



1 Set of hard solid ID jaws

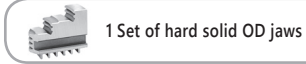

1 Set of hard solid OD jaws



1 Wrench

Spare parts 99-141

Technical data 142-148

Code No.	Type
7-802-0615	3214-6"-5
7-802-0815	3214-8"-5
7-802-0816	3214-8"-6
7-802-1015	3214-10"-5
7-802-1016	3214-10"-6
7-802-1018	3214-10"-8
7-802-1216	3214-12"-6
7-802-1218	3214-12"-8
7-802-1616	3214-16"-6
7-802-1618	3214-16"-8
7-802-1619	3214-16"-11
7-802-2028	3214-20"-8
7-802-2029	3214-20"-11
7-802-2511	3214-25"-11
7-802-2515	3214-25"-15

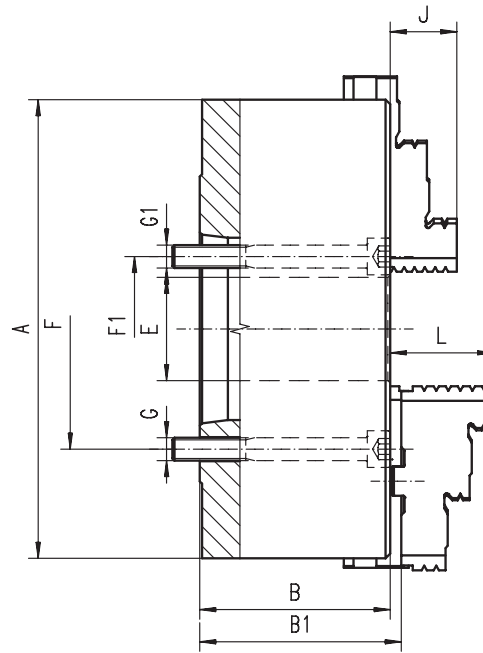

■ Ground working surfaces

A [in]	Taper Size	B [in]	B1 [in]	E [in]	F [in]	F1 [in]	Number of bolts	3214		3215		J [in]	L [in]	Weight [lbs]
								G	G1	G	G1			
6.30	5	3.21	3.40	1.65	-	2.44	3	-	3xM10	-	7/16-14	0.63	1.69	22.05
7.87	5	3.58	3.77	1.65	-	2.44	3	-	3xM10	-	7/16-14	1.14	1.77	41.89
7.87	6	3.58	3.77	2.17	-	3.25	3	-	3xM12	-	1/2-13	1.14	1.77	41.89
9.84	5	4.07	4.22	2.99	4.13	-	6	6xM10	-	7/16-14	-	1.34	2.09	70.55
9.84	6	4.07	4.22	2.17	-	3.25	6	-	6xM12	-	1/2-13	1.34	2.09	70.55
9.84	8	4.07	4.22	2.99	-	4.37	6	-	6xM16	-	5/8-11	1.34	2.09	70.55
12.40	6	4.63	4.83	4.06	5.25	-	6	6xM12	-	1/2-13	-	1.69	2.24	121.25
12.40	8	4.63	4.83	3.15	-	4.37	6	-	6xM16	-	5/8-11	1.69	2.24	121.25
15.75	6	5.06	5.41	4.06	5.25	-	6	6xM12	-	1/2-13	-	2.17	2.64	202.83
15.75	8	5.06	5.41	5.35	6.75	-	6	6xM16	-	5/8-11	-	2.17	2.64	202.83
15.75	11	5.06	5.41	5.12	-	6.50	6	-	6xM 20	-	3/4-10	2.17	2.64	202.83
19.69	8	5.75	6.19	5.35	6.75	-	6	6xM16	-	5/8-11	-	2.36	3.11	352.74
19.69	11	5.75	6.19	7.48	9.25	-	6	6xM20	-	3/4-10	-	2.36	3.11	352.74
24.80	11	6.50	6.92	7.48	9.25	-	6	6xM20	-	3/4-10	-	2.76	3.43	628.32
24.80	15	6.50	6.92	7.48	-	9.75	6	-	6xM24	-	7/8-9	2.76	3.43	628.32

Larger diameters available on page 82-93!

3215



Standard accessories

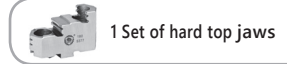

1 Set of hard top jaws

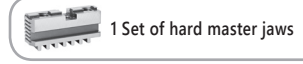

1 Set of hard master jaws



1 Wrench

Spare parts 99-141

Technical data 142-148

Type	Code No.
3215-6"-5	7-801-0615
3215-8"-5	7-801-0815
3215-8"-6	7-801-0816
3215-10"-5	7-801-1015
3215-10"-6	7-801-1016
3215-10"-8	7-801-1018
3215-12"-6	7-801-1216
3215-12"-8	7-801-1218
3215-16"-6	7-801-1616
3215-16"-8	7-801-1618
3215-16"-11	7-801-1619
3215-20"-8	7-801-2028
3215-20"-11	7-801-2029
3215-25"-11	7-801-2511
3215-25"-15	7-801-2515