



T-Nuts

Page 234



HARD TOP JAWS • FOR CHUCKS 2605-K

METRIC SERRATION 1.5 MM X 60°

BISON Chuck Type	Code No.	Chuck Size	A	B	C	D H7	F	G	H	M	Screws	Weight / set
	4 jaw set	[mm]	[mm]				[mm]	[mm]	[mm]	[mm]		[lbs]
2605-135-34K	7-787-405	135	23	53	36	10	13	14	1.5 mm x 60°	10	M8	1.10
2605-160-45K	7-787-406	160	32	64	43	12	12.5	20	1.5 mm x 60°	10	M10	2.87
2605-200-52K	7-787-408	200	35	79	49	14	14.5	25	1.5 mm x 60°	12	M12	4.63
2605-250-75K	7-787-410	250	40	102	54	16	21	30	1.5 mm x 60°	14	M12	6.39
2605-315-91K	7-787-412	315	45	102	58	21	21	30	1.5 mm x 60°	14	M16	8.82

Ø 135 - 315 mm

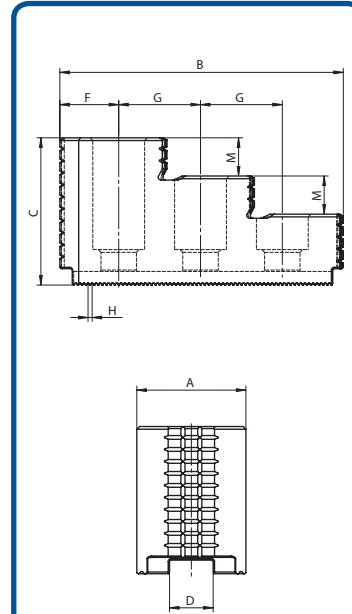

- 1
- 2
- 3
- 4
- 5
- 6



T-Nuts

Page 234



HARD TOP JAWS • FOR CHUCKS 2605

INCH SERRATION 1/16" X 90°

BISON Chuck Type	Code No.	Chuck Size	A	B	C	D H7	F	G	H	M	Screws	Weight / set
	4 jaw set	[mm]	[mm]				[in]	[mm]	[mm]	[lbs]		
2605-160-45	7-787-4060	160	28	76	45	17	14	24	1/16" x 90°	10	M12	2.87
2605-200-52	7-787-4080	200	32	78	49	17	14.5	24.5	1/16" x 90°	12	M12	3.97
2605-250-75	7-787-4100	250	40	102	58	21	19	32	1/16" x 90°	14	M16	7.72
2605-315-91	7-787-4120	315	40	102	58	21	19	32	1/16" x 90°	14	M16	7.72

Ø 160 - 315 mm

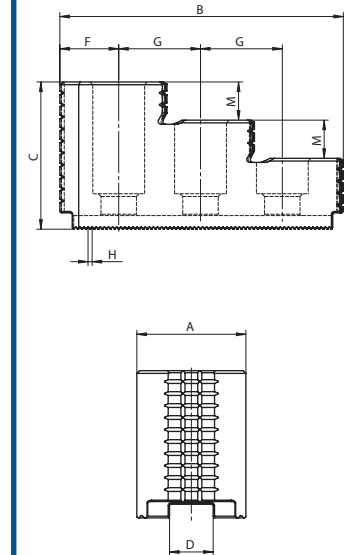

- SGT 2605-K
- SGT 2605

