

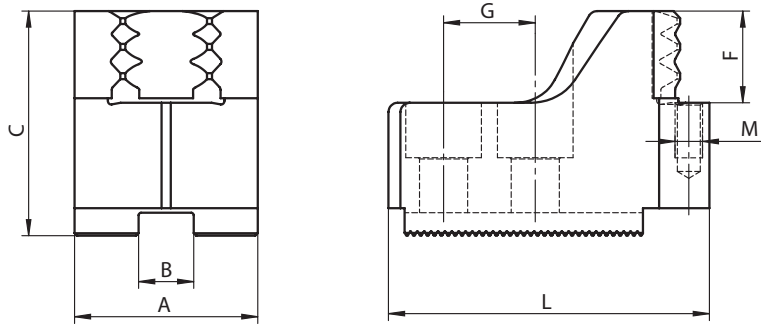

- OUTSIDE DIAMETER CLAMPING
- 1.5 MM X 60° SERRATION



- 1
- 2
- 3
- 4
- 5



T-Nuts - Page 22



Workpiece stops - Page 23

BISON Chuck Type	Code No.	Chuck Size	Clamping range	A	B	C	F	G	L	M	Weight / set
											[lbs]
3 jaw set											
[mm]											
2405-160-45K	7-792-0061	160	28 - 55	40	12	49	20	20	74.0	M6	4.19
2405-160-45K	7-792-0062	160	36 - 68	40	12	49	20	20	68.0	M6	3.75
2405-160-45K	7-792-0063	160	50 - 81	40	12	49	20	20	70.0	M6	3.97
2405-160-45K	7-792-0064	160	63 - 97	40	12	49	20	20	60.0	M6	3.31
2405-160-45K	7-792-0065	160	80 - 112	40	12	49	20	20	60.0	M6	3.75
2405-200-52K	7-792-0081	200	29 - 72	40	14	49	20	25	83.0	M6	4.41
2405-200-52K	7-792-0082	200	63 - 100	40	14	49	20	25	69.0	M6	3.97
2405-200-52K	7-792-0083	200	92 - 129	40	14	49	20	25	57.0	M6	3.31
2405-200-52K	7-792-0084	200	111 - 158	40	14	49	20	25	50.0	M6	2.65
2405-200-52K	7-792-0085	200	150 - 189	40	14	49	20	25	73.5	M6	4.41
2405-250-75K	7-792-0101	250	40 - 94	40	16	59	25	30	97.0	M6	6.39
2405-250-75K	7-792-0102	250	78 - 130	40	16	59	25	30	78.0	M6	4.85
2405-250-75K	7-792-0103	250	121 - 173	40	16	59	25	30	67.0	M6	4.41
2405-250-75K	7-792-0104	250	166 - 215	40	16	59	25	30	66.5	M6	4.41
2405-250-75K	7-792-0105	250	203 - 252	40	16	59	25	30	85.5	M6	5.73
2405-315-91K	7-792-0122	315	41 - 127	50	21	59	30	30	120.0	M8	8.82
2405-315-91K	7-792-0121	315	89 - 181	50	21	59	30	30	95.0	M8	7.05
2405-315-91K	7-792-0123	315	153 - 245	50	21	59	30	30	75.0	M8	5.29
2405-315-91K	7-792-0124	315	219 - 300	50	21	59	30	30	85.0	M8	6.83

1.5 MM X 60°